

# Technical data sheet



## Product features

### Pizza oven counter top 1 chamber

<b>Model</b>	<b>SAP Code</b>	00000764
--------------	-----------------	----------



- Pizza capacity [cm]: 1x 33 cm
- Stoneplates: No
- Material: Stainless steel
- Control type: Mechanical
- Type of handle: Short, plastic
- Steam protection: No
- Chimney for moisture extraction: No
- Adjustable chimney: No
- Interior lighting: No

<b>SAP Code</b>	00000764	<b>Loading</b>	230 V / 1N - 50 Hz
<b>Net Width [mm]</b>	505	<b>Minimum device temperature [°C]</b>	50
<b>Net Depth [mm]</b>	566	<b>Maximum device temperature [°C]</b>	300
<b>Net Height [mm]</b>	214	<b>Width of internal part [mm]</b>	340
<b>Net Weight [kg]</b>	15.00	<b>Depth of internal part [mm]</b>	340
<b>Power electric [kW]</b>	1.750	<b>Pizza capacity [cm]</b>	1x 33 cm

# Technical data sheet



Technical drawing

## Pizza oven counter top 1 chamber

Model

SAP Code

00000764

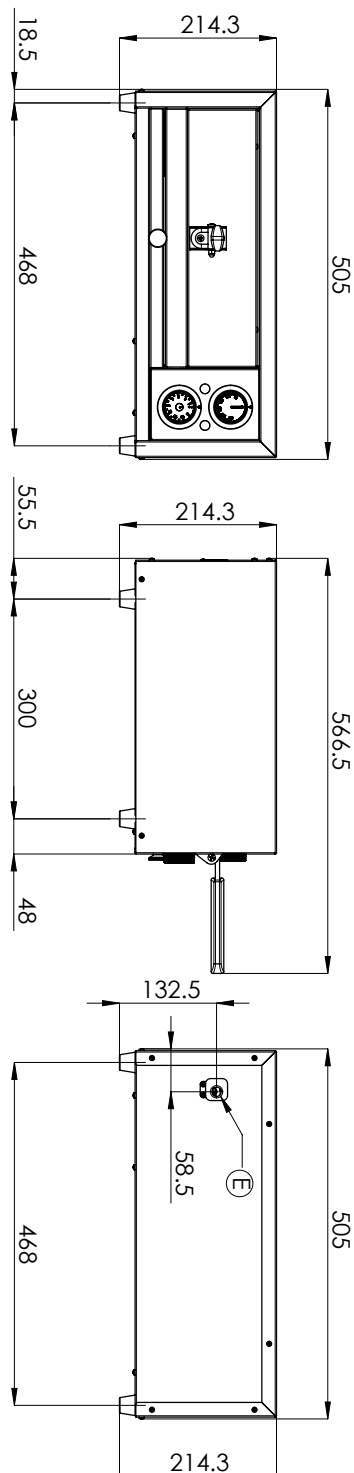

# Technical data sheet



## Product benefits

### Pizza oven counter top 1 chamber

Model

SAP Code

00000764

1

#### **Stainless steel outer shell construction**

easy cleaning, high hygienic standard, long service life

- cost savings on the purchase of a new machine, time savings on cleaning and cleaning comfort

2

#### **Manual controls**

clear and simple user-friendly temperature settings

- quick and easy for the user to operate, no training required for operation long service life

3

#### **The device is powered from a regular 230v network**

the device can be connected anywhere, in case of sufficient securing

- no need for sufficient costs if I do not have a 400V supply

4

#### **Heating the chamber in the temperature range of 50 to 300°C**

heating the chamber in the temperature range of 30 to 300 °C

- simple small compact pizza oven at a good price. ideal for chilled / frozen pizza where we save time and costs

# Technical data sheet



## Technical parameters

### Pizza oven counter top 1 chamber

**Model**

**SAP Code**

00000764

**1. SAP Code:**

00000764

**2. Net Width [mm]:**

505

**3. Net Depth [mm]:**

566

**4. Net Height [mm]:**

214

**5. Net Weight [kg]:**

15.00

**6. Gross Width [mm]:**

485

**7. Gross depth [mm]:**

570

**8. Gross Height [mm]:**

260

**9. Gross Weight [kg]:**

16.00

**10. Material:**

Stainless steel

**11. Device type:**

Electric unit

**12. Power electric [kW]:**

1.750

**13. Loading:**

230 V / 1N - 50 Hz

**14. Control type:**

Mechanical

**15. Width of internal part [mm]:**

340

**16. Depth of internal part [mm]:**

340

**17. Minimum device temperature [°C]:**

50

**18. Maximum device temperature [°C]:**

300

**19. Stacking availability:**

Yes

**20. Pizza capacity [cm]:**

1x 33 cm

**21. Indicators:**

operation

**22. Number of internal parts:**

1

**23. On/Off button:**

Yes

**24. Type of handle:**

Short, plastic

**25. Steam protection:**

No

**26. Protection of controls:**

IPX4

**27. Stoneplates:**

No

**28. Interior lighting:**

No

# Technical data sheet



Technical parameters

## Pizza oven counter top 1 chamber

Model

SAP Code

00000764

### 29. Safety element:

safety thermostat

### 32. Adjustable chimney:

No

### 30. Number of cavities:

1

### 33. Cross-section of conductors CU [mm<sup>2</sup>]:

0,5

– Výkon (kW): 2,4-3,3 (230 V)

### 31. Chimney for moisture extraction:

No